

Overview of Testing Results and Corrective Actions for Lead in Drinking Water Naval Submarine Base New London Child Development Center and Youth Center

The Navy is committed to maintaining safe drinking water on its installations. Drinking water supplied to the Navy by Groton Utilities and the Navy's own water distribution systems serving the main base and the housing areas are regularly tested and are in compliance with the Safe Drinking Water Act. Because lead exposure is a particular concern for children, and lead may be added to drinking water through the pipes, fittings, solder, and fixtures inside a building, the Environmental Protection Agency (EPA) recommends, but does not mandate, that we test the lead content of drinking water in priority areas such as youth centers (YCs) and child development centers (CDCs). The Navy has adopted the recommendation as policy.

Contractor personnel conducted lead testing at the Naval Submarine Base New London (SUBASENLON) CDC and YC in December 2018 and March 2019 in accordance with Navy and EPA guidelines. Samples were sent to a state-certified laboratory for analysis.

At the SUBASENLON CDC and YC, all outlets, including those used for drinking, cooking, and washing were scheduled for testing. A total of 113 samples were collected and sent for analysis. All of these samples had results showing levels below the Navy action level for lead in drinking water in schools and childcare centers of 15 parts per billion (ppb). Samples from five outlets were either not taken or test results were deemed invalid due to insufficient flow needed to obtain a valid sample. One of the outlets was an unused water fountain located in CDC386. This fountain is scheduled for repair and will be sampled upon completion. Four outlets are exterior spigots that are not used by CDC or YC staff and will either be labeled as not for drinking or cut and capped. Specific outlets are identified on the included floor plans as noted below.

It should be noted that **faucet aerators** (or tap aerators) are commonly found at the tip of modern indoor water faucets to help save water and reduce splashing and these are also used at the CDC and YC. However, caution must be used as the aerator and screen can trap debris which can accumulate lead. In order to maintain drinking water quality in the CDC and YC, Navy policy mandates that all aerators used at these facilities be checked and cleaned regularly. CDC staff and the Public Works Department at SUBASENLON work together to ensure that all aerators used at the CDC and YC are maintained in strict accordance with the Navy policy.



A copy of all test results for the CDC (consisting of three separate wings, CT186, CT383 and CT386) and the YC (main facility and addition) are enclosed for your information. The test results are presented in two tables:

- Table 1 **Summary of Results** summarizes the data by category of use (e.g., drinking, cooking, washing).
- Table 2 **Summary Statistics** summarizes all the data.

For your convenience, floor plans have also been included to show the locations for the fixtures that were sampled in December of 2018 and March 2019.

Table 1 provides a description of each sampling location using three columns; *Category*, *Sampling ID*, and *Outlet Description*. The *Category* column gives information about whether the outlet is used for drinking water (water fountain), cooking (food preparation), or washing (primarily hand-washing or brushing teeth). The *Sample ID* column is the identification used to label each sample bottle. The *Outlet Description* column contains additional information to describe the outlet sampled under each category.

The next set of columns in **Table 1** provide *Initial Sampling Results* which show the results as below the Navy action level.

EPA sampling protocol requires water to not be used for between 8 and 18 hours prior to first draw sampling. Therefore, *Initial Sampling Results were from* first draw samples collected early in the morning before any water was used.

To learn more about lead in drinking water in schools and day care centers visit the following EPA website: <https://www.epa.gov/dwreginfo/lead-drinking-water-schools-and-child-care-facilities>.

To learn more about water quality from your public water supplier or see specific water quality information regarding SUBASENLON and Housing, see their annual water quality reports at the following websites:

http://grotonutilities.com/download/water/water_quality_reports/2017.pdf

https://www.cnic.navy.mil/regions/cnrma/om/environmental_support/water_quality_information.html

To answer any questions, you may have on the sampling program contact the SUBASENLON Public Affairs Officer at (860) 694-5690. If you have any health questions or concerns, you are encouraged to contact your health care provider or, if you are a TRICARE beneficiary, use the resources at the Naval Branch Health Clinic Groton.

Enclosures:

1. Complete Test Results
2. Floor Plan of the CDC and YC complexes

Priority Areas Lead Testing and Corrective Actions - DECEMBER 2018
SUBASENLON Child Development Center
CT186, CT383, CT386

Table 1. Summary of Results

SAMPLING LOCATION DESCRIPTION					INITIAL SAMPLING RESULTS			RE-SAMPLING RESULTS			CORRECTIVE ACTIONS	POST REMEDIATION SAMPLING	
CATEGORY Water Intended For:	BUILDING	ROOM	SAMPLE ID	Outlet Description	First Draw (ppb)	Retest required?	Date Fixture Secured?	Water Fountain 15 min. Follow up Flush Sample - Collected day before First Draw Sampling	First Draw (ppb)	Follow up Flush - Collected 30 seconds after First Draw Sampling (ppb)	Description	Target Level = 15 ppb	
												Detection Limit = 1 ppb	Detection Limit = 1 ppb
SAMPLING DATE ---->					12/15/2018								
RESULTS DATE ---->					12/21/2018								
DRINKING	CT386	PRETODDLER 16	NL-CT386-RMPT16-WFCOMB-FD	CLASSROOM SINK	<1	No							
DRINKING	CT383	HALLWAY	NL-CT383-HW-WFC-FD	WATER FOUNTAIN COOLER	<1	No							
DRINKING	CT383	PRESCHOOL 1-4	NL-CT383-RMPS14-WFCOMB(B)-FD	CLASSROOM SINK	<1	No							
DRINKING	CT383	TODDLER 2-4	NL-CT383-RMTD24-WFCOMB-FD	CLASSROOM SINK	<1	No							
DRINKING	CT383	PRESCHOOL 2-4	NL-CT383-RMPS24-WFCOMB(B)-FD	CLASSROOM SINK	<1	No							
DRINKING	CT383	TODDLER 1-4	NL-CT383-RMTD14-WFCOMB-FD	CLASSROOM SINK	<1	No							
DRINKING	CT386	TODDLER 19	NL-CT386-RMTD19-WFCOMB-FD	CLASSROOM SINK	<1	No							
DRINKING	CT386	TODDLER 18	NL-CT386-RMTD18-WFCOMB-FD	CLASSROOM SINK	<1	No							
DRINKING	CT386	HALLWAY	NL-CT386-HW-WFC-FD	WATER FOUNTAIN COOLER	<1	No							
COOKING	CT383	KITCHEN	NL-CT383-K-K(A)-FD	KITCHEN SINK	<1	No							
COOKING	CT383	KITCHEN	NL-CT383-K-K(B)-FD	KITCHEN SINK	<1	No							
COOKING	CT383	KITCHEN	NL-CT383-K-K(C)-FD	KITCHEN SINK	<1	No							
COOKING	CT386	KITCHEN	NL-CT386-K-K(A)-FD	KITCHEN SINK	4.6	No							
COOKING	CT386	KITCHEN	NL-CT386-K-K(B)-FD	KITCHEN SINK	1.8	No							
COOKING	CT386	KITCHEN	NL-CT386-K-K(C)-FD	KITCHEN SINK	<1	No							
WASHING	CT186	PRETODDLER 2-1	NL-CT186-BATHPT21-HHW-FD	BATHROOM SINK	<1	No							
WASHING	CT186	PRETODDLER 2-1	NL-CT186-BATHPT21-LHW(A)-FD	BATHROOM SINK	<1	No							
WASHING	CT186	PRETODDLER 2-1	NL-CT186-BATHPT21-LHW(B)-FD	BATHROOM SINK	<1	No							
WASHING	CT186	PRETODDLER 2-1	NL-CT186-BATHPT21-LHW(C)-FD	BATHROOM SINK	<1	No							
WASHING	CT186	PRETODDLER 2-1	NL-CT186-BATHPT21-LHW(D)-FD	BATHROOM SINK	<1	No							

Priority Areas Lead Testing and Corrective Actions - DECEMBER 2018
SUBASENLON Child Development Center
CT186, CT383, CT386

Table 1. Summary of Results

SAMPLING LOCATION DESCRIPTION					INITIAL SAMPLING RESULTS			RE-SAMPLING RESULTS			CORRECTIVE ACTIONS	POST REMEDIATION SAMPLING	
CATEGORY Water Intended For:	BUILDING	ROOM	SAMPLE ID	Outlet Description	Target Level = 15 ppb			Water Fountain 15 min. Follow up Flush Sample - Collected day before First Draw Sampling	First Draw (ppb) Detection Limit = 1 ppb	Follow up Flush - Collected 30 seconds after First Draw Sampling (ppb) Detection Limit = 1 ppb	Description	Target Level = 15 ppb	
					First Draw (ppb)	Retest required?	Date Fixture Secured?					First Draw (ppb)	Follow up Flush - Collected 30 seconds after First Draw Sampling (ppb)
SAMPLING DATE ---->					12/15/2018								
RESULTS DATE ---->					12/21/2018								
WASHING	CT186	PRETODDLER 2-1	NL-CT186-RMPT21-HHW-FD	CLASSROOM SINK	<1	No							
WASHING	CT186	TODDLER 1-1	NL-CT186-BATHD11-HHW-FD	BATHROOM SINK	<1	No							
WASHING	CT186	TODDLER 1-1	NL-CT186-BATHD11-LHW(A)-FD	BATHROOM SINK	<1	No							
WASHING	CT186	TODDLER 1-1	NL-CT186-BATHD11-LHW(B)-FD	BATHROOM SINK	<1	No							
WASHING	CT186	ADULT BATH	NL-CT186-BATH-HHW-FD	STAFF BATHROOM SINK	<1	No							
WASHING	CT186	PRESCHOOL 2-1	NL-CT186-BATHPS21-LHW(A)-FD	BATHROOM SINK	<1	No							
WASHING	CT186	PRESCHOOL 2-1	NL-CT186-BATHPS21-LHW(B)-FD	BATHROOM SINK	<1	No							
WASHING	CT186	PRESCHOOL 2-1	NL-CT186-RMPS21-HHW-FD	CLASSROOM SINK	<1	No							
WASHING	CT186	PRESCHOOL 1-1	NL-CT186-BATHPS11-LHW(A)-FD	BATHROOM SINK	3.8	No							
WASHING	CT186	PRESCHOOL 1-1	NL-CT186-BATHPS11-LHW(B)-FD	BATHROOM SINK	6.2	No							
WASHING	CT383	INFANT 1-4	NL-CT383-RMIN14-HHW(A)-FD	CLASSROOM SINK	2.1	No							
WASHING	CT383	INFANT 1-4	NL-CT383-RMIN14-HHW(B)-FD	CLASSROOM SINK	<1	No							
WASHING	CT383	ADULT BATH	NL-CT383-BATH-HHW-FD	STAFF BATHROOM SINK	<1	No							
WASHING	CT383	LAUNDRY	NL-CT383-UT-HHW-FD	LAUNDRY ROOM SINK	1.1	No							
WASHING	CT383	STAFF LOUNGE	NL-CT383-LOUNGE-HHW-FD	STAFF LOUNGE	<1	No							
WASHING	CT383	PRESCHOOL 1-4	NL-CT383-BATHPS14-LHW-FD	BATHROOM SINK	<1	No							
WASHING	CT383	PRESCHOOL 1-4	NL-CT383-RMPS14-HHW-FD	CLASSROOM SINK	<1	No							
WASHING	CT383	PRESCHOOL 1-4	NL-CT383-RMPS14-HWCMB(B)-FD	CLASSROOM SINK	<1	No							
WASHING	CT383	TODDLER 2-4	NL-CT383-BATHD24-LHW-FD	BATHROOM SINK	<1	No							
WASHING	CT383	TODDLER 2-4	NL-CT383-RMTD24-HHW-FD	CLASSROOM SINK	<1	No							
WASHING	CT383	TODDLER 2-4	NL-CT383-RMTD24-HWCMB-FD	CLASSROOM SINK	<1	No							
WASHING	CT383	PRESCHOOL 2-4	NL-CT383-BATHPS24-LHW-FD	BATHROOM SINK	<1	No							
WASHING	CT383	PRESCHOOL 2-4	NL-CT383-RMPS24-HHW-FD	CLASSROOM SINK	<1	No							
WASHING	CT383	PRESCHOOL 2-4	NL-CT383-RMPS24-HWCMB(B)-FD	CLASSROOM SINK	<1	No							
WASHING	CT383	TODDLER 1-4	NL-CT383-BATHD14-LHW-FD	BATHROOM SINK	<1	No							
WASHING	CT383	TODDLER 1-4	NL-CT383-RMTD14-HHW-FD	CLASSROOM SINK	<1	No							
WASHING	CT383	TODDLER 1-4	NL-CT383-RMTD14-HWCMB-FD	CLASSROOM SINK	<1	No							
WASHING	CT386	TODDLER 19	NL-CT386-BATHD19-LHW(A)-FD	BATHROOM SINK	<1	No							
WASHING	CT386	TODDLER 19	NL-CT386-BATHD19-LHW(B)-FD	BATHROOM SINK	<1	No							
WASHING	CT386	TODDLER 19	NL-CT386-RMTD19-HHW-FD	CLASSROOM SINK	<1	No							
WASHING	CT386	TODDLER 19	NL-CT386-RMTD19-HWCMB-FD	CLASSROOM SINK	<1	No							
WASHING	CT386	INFANT 12	NL-CT386-RMIN12-HHW(A)-FD	CLASSROOM SINK	<1	No							
WASHING	CT386	INFANT 13	NL-CT386-RMIN13-HHW-FD	CLASSROOM SINK	<1	No							
WASHING	CT386	INFANT 14	NL-CT386-RMIN14-HHW(A)-FD	CLASSROOM SINK	<1	No							
WASHING	CT386	INFANT 14	NL-CT386-RMIN14-HHW(B)-FD	CLASSROOM SINK	<1	No							
WASHING	CT386	PRETODDLER 16	NL-CT386-RMPT16-LHW-FD	BATHROOM SINK	<1	No							
WASHING	CT386	PRETODDLER 17	NL-CT386-BATHPT17-LHW-FD	BATHROOM SINK	<1	No							
WASHING	CT386	PRETODDLER 17	NL-CT386-RMPT17-HHW-FD	CLASSROOM SINK	<1	No							
WASHING	CT386	TODDLER 18	NL-CT386-BATHD18-LHW(A)-FD	BATHROOM SINK	<1	No							
WASHING	CT386	TODDLER 18	NL-CT386-BATHD18-LHW(B)-FD	BATHROOM SINK	<1	No							
WASHING	CT386	TODDLER 18	NL-CT386-RMTD18-HWCMB-FD	CLASSROOM SINK	<1	No							

Priority Areas Lead Testing and Corrective Actions - DECEMBER 2018
SUBASENLON Child Development Center
CT186, CT383, CT386

Table 1. Summary of Results

SAMPLING LOCATION DESCRIPTION					INITIAL SAMPLING RESULTS			RE-SAMPLING RESULTS			CORRECTIVE ACTIONS	POST REMEDIATION SAMPLING	
CATEGORY Water Intended For:	BUILDING	ROOM	SAMPLE ID	Outlet Description	First Draw (ppb)	Retest required?	Date Fixture Secured?	Water Fountain 15 min. Follow up Flush Sample - Collected day before First Draw Sampling	First Draw (ppb)	Follow up Flush - Collected 30 seconds after First Draw Sampling (ppb)	Description	Target Level = 15 ppb	
												First Draw (ppb)	Follow up Flush - Collected 30 seconds after First Draw Sampling (ppb)
					Detection Limit = 1 ppb				Detection Limit = 1 ppb	Detection Limit = 1 ppb		Detection Limit = 1 ppb	Detection Limit = 1 ppb
SAMPLING DATE ---->					12/15/2018								
RESULTS DATE ---->					12/21/2018								
WASHING	CT386	ADULT BATH	NL-CT386-BATH-HHW-FD	STAFF BATHROOM SINK	<1	No							
WASHING	CT386	INFANT 11	NL-CT386-RMIN11-HHW-FD	CLASSROOM SINK	<1	No							
WASHING	CT386	INFANT 12	NL-CT386-RMIN12-HHW(B)-FD	CLASSROOM SINK	<1	No							
WASHING	CT386	LAUNDRY	NL-CT386-UT-HHW-FD	LAUNDRY ROOM SINIK	1.7	No							
WASHING	CT386	STAFF LOUNGE	NL-CT386-LOUNGE-HHW-FD	LOUNGE SINK	<1	No							
WASHING	CT386	PRETODDLER 16	NL-CT386-RMPT16-HWCOMB-FD	CLASSROOM SINK	<1	No							
WASHING	CT386	PRETODDLER 17	NL-CT386-RMPT17-HWCOMB-FD	CLASSROOM SINK	<1	No							
OUTDOOR	CT186	OUTSIDE	NL-CT186-ESB-SP-FD	OUTDOOR SPIGOT	<1	No							
OUTDOOR	CT383	OUTSIDE	NL-CT383-ESB-SP-FD	OUTDOOR SPIGOT	1.4	No							
OUTDOOR	CT383	OUTSIDE	NL-CT383-NSB-SP-FD	OUTDOOR SPIGOT	3.0	No							
OUTDOOR	CT383	OUTSIDE	NL-CT383-WSB-SP-FD	OUTDOOR SPIGOT	1.6	No							
OUTDOOR	CT386	OUTSIDE	NL-CT386-ESB-SP-FD	OUTDOOR SPIGOT	<1	No							
OUTDOOR	CT186	OUTSIDE	NL-CT186-WSB(A)-SP-FD	OUTDOOR SPIGOT	<1	No							
OUTDOOR	CT186	OUTSIDE	NL-CT186-WSB(B)-SP-FD	OUTDOOR SPIGOT	See Note Below	See Note Below							

Note:
Sample ID NL-CT186-WSB(B)-SP-FD was invalidated due to insufficient flow; this is an exterior spigot on the west side of CT186, it is not used and will be cut and capped.

Table 2. Summary Statistics

CATEGORY	INITIAL SAMPLING RESULTS	RE-SAMPLING RESULTS (For Samples > 15 ppb)			POST REMEDIATION RESULTS
	Sample Date: 10/22/2013	Sample Date: 10/26/2013			
	First Draw	First Draw > 15 ppb	Water Fountain Follow up Flush Sample- Collected day before First Draw Sampling	Follow up Flush Collected 30 seconds after First Draw Sampling > 15 ppb	First Draw > 15 ppb
Total Drinking	9	N/A			
Total Drinking > 15 ppb	0	N/A			
Total Cook/Brush	6	N/A			
Total Cook/Brush > 15 ppb	0	N/A			
Total Washing	53	N/A			
Total Washing > 15 ppb	0	N/A			
Outdoor	7	N/A			
Outdoor > 15 ppb	0	N/A			
Total Samples	75	N/A			
Total Samples > 15 ppb	0	N/A			

CHILD DEVELOPMENT CENTER (CDC) - CT186

LEAD SAMPLING DECEMBER 2018

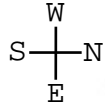

NOTE: All Results <1 ppb except as noted.

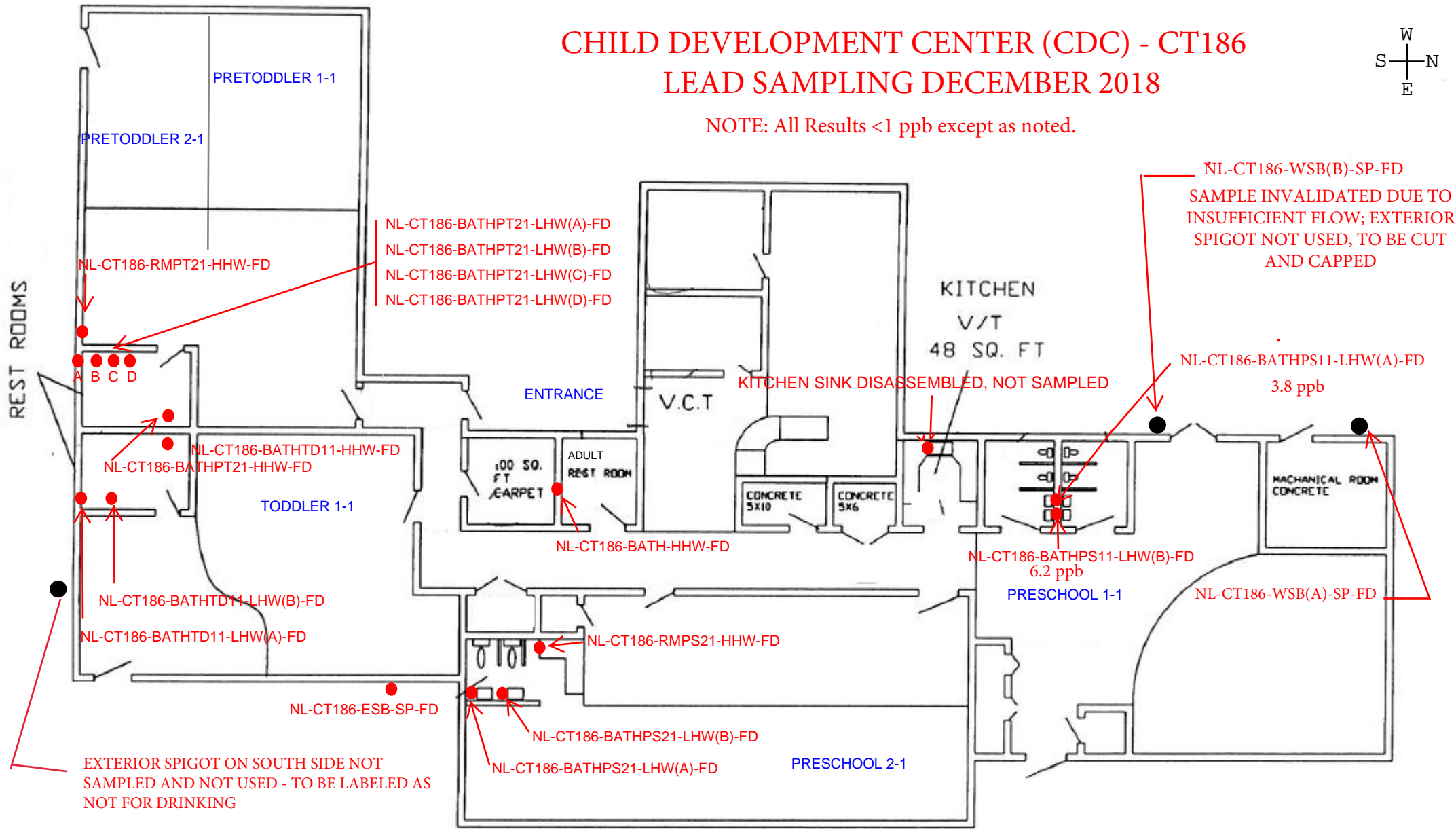

B-CT. 186 CHILD CARE CENTER		
NO-SCALE	8/00	J.T.B

CHILD DEVELOPMENT CENTER PRIORITY AREA SAMPLING - DECEMBER 2018

NOTE: ALL RESULTS <1 ppb UNLESS NOTED OTHERWISE

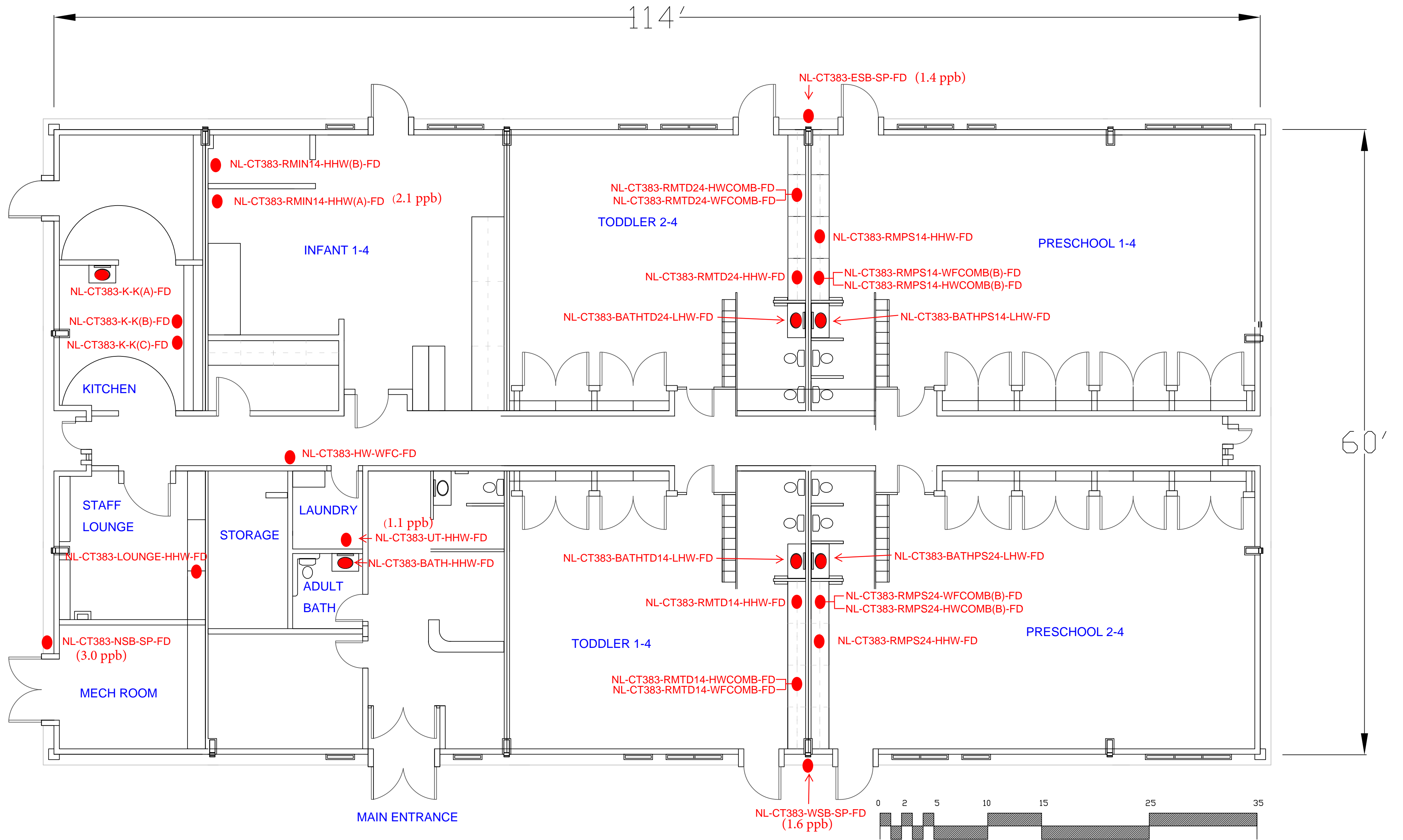
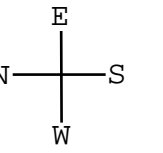

Child Development Center - CT-383

NL-CT386-WSB-SP-FD - NOT SAMPLED DUE TO INSUFFICIENT FLOW. TO BE LABELED AS NOT FOR DRINKING

WATER FOUNTAIN (PUSH BUTTON) PART OF COMBINATION SINK NOT WORKING PROPERLY AND NOT SAMPLED; TO BE REPAIRED AND SAMPLED UPON COMPLETION.

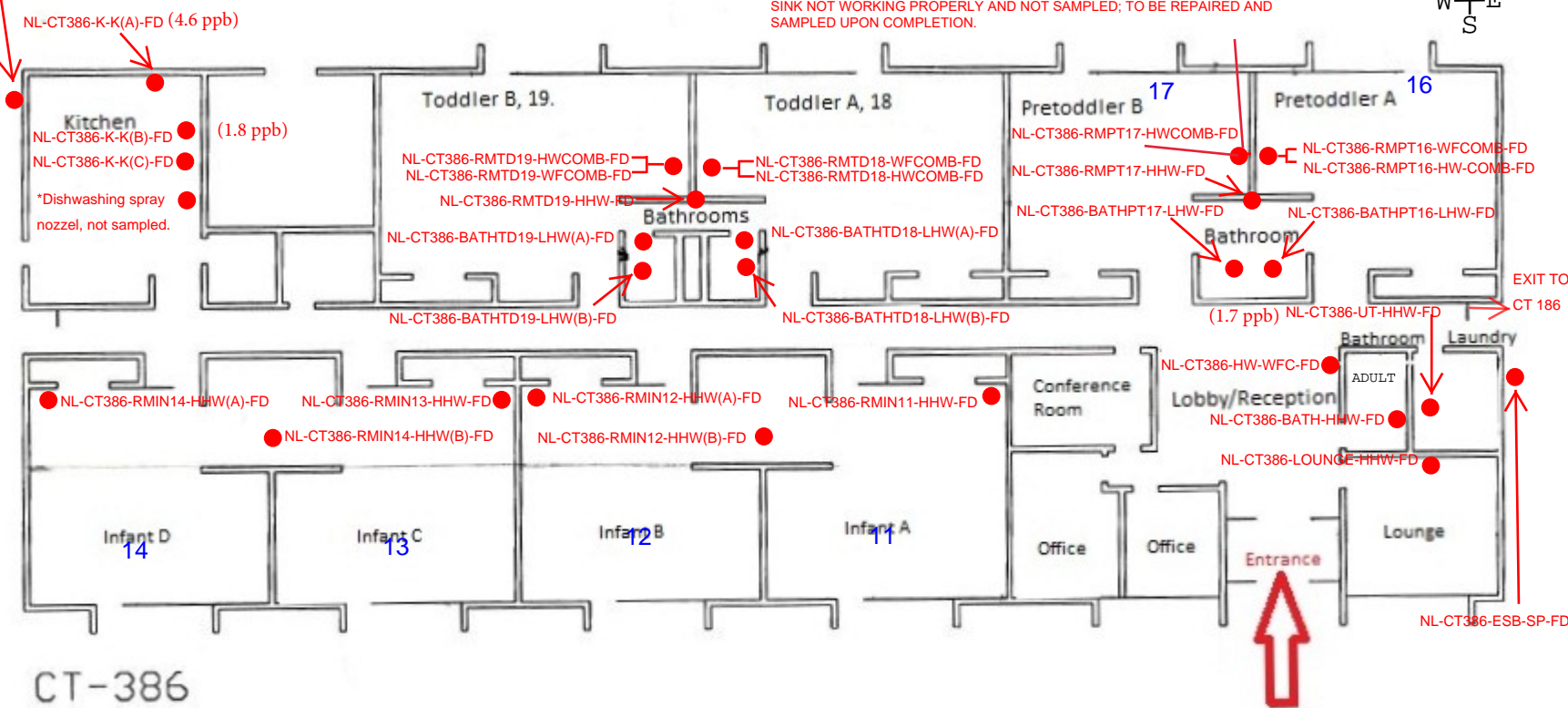

CHILD DEVELOPMENT CENTER CT386 PRIORITY AREA SAMPLING

DECEMBER 2018 - Note: ALL RESULTS <1 ppb UNLESS OTHERWISE NOTED

NAVY YOUTH CENTER DRINKING WATER TESTING
29 HICKORY DRIVE, GROTON, CT 06340
DECEMBER 2018

Summary of Results		INITIAL SAMPLING RESULTS			RE-SAMPLING RESULTS			CORRECTIVE ACTIONS	POST REMEDIATION SAMPLING RESULTS		
SAMPLING LOCATION DESCRIPTION		Target Level = 15 ppb			Target Level = 15 ppb				Target Level = 15 ppb		
CATEGORY	ROOM	SAMPLE ID	First Draw Detection Limit = 1 ppb	Retest required?	Date Fixture Secured?	ROOM	SAMPLE ID	First Draw (ppb) Detection Limit = 1 ppb	Description	First Draw (ppb) Detection Limit = 1 ppb	Follow up Flush (ppb) (Collected 30 seconds after First Draw Sampling) Detection Limit = 1 ppb
Water Intended For:	ROOM	SAMPLE ID				ROOM	SAMPLE ID		Description		
		SAMPLING DATE ----> 12/15/2018 RESULTS DATE -----> 12/21/2018					SAMPLING DATE ----> RESULTS DATE ---->			mm/dd/yyyy mm/dd/yyyy	
Drinking	Hallway	NL-YC-HALLWAY-WFC-FD	<1	NO							
Drinking	Lobby	NL-YC-LOBBY-WFC-FD	<1	NO							
Washing	Boys Bathroom	NL-YC-BOYSBATH-HHW (A)-FD	8.2	NO							
Washing	Boys Bathroom	NL-YC-BOYSBATH-HHW (B)-FD	<1	NO							
Washing	Boys Bathroom	NL-YC-BOYSBATH-HHW (C)-FD	<1	NO							
Washing	Boys Bathroom	NL-YC-BOYSBATH-HHW (D)-FD	<1	NO							
Washing	Boys Bathroom	NL-YC-BOYSBATH-HHW (E)-FD	<1	NO							
Washing	Girls Bathroom	NL-YC-GIRLSBATH-HHW (A)-FD	<1	NO							
Washing	Girls Bathroom	NL-YC-GIRLSBATH-HHW (B)-FD	<1	NO							
Washing	Girls Bathroom	NL-YC-GIRLSBATH-HHW (C)-FD	<1	NO							
Washing	Girls Bathroom	NL-YC-GIRLSBATH-HHW (D)-FD	<1	NO							
Washing	Girls Bathroom	NL-YC-GIRLSBATH-HHW (E)-FD	<1	NO							
Washing	Rm 109	NL-YC-RM109-HHW-FD	<1	NO							
Washing	Rm 116	NL-YC-RM116-HHW-FD	5.5	NO							
Washing	Snack Area	NL-YC-SNACK-HHW-FD	<1	NO							
Washing	Utility Closet	NL-YC-UT-HHW-FD	<1 (See Note Below)	NO							
Outdoor	Outside	NL-YC-WESTHOSE (A)-FD	2.7	NO							
Outdoor	Outside	NL-YC-WESTHOSE (B)-FD	2.6	NO							
Outdoor	Outside	NL-YC-EASTHOSE-FD	1.7	NO							

NOTE: Sink in utility closet, sample ID NL-YC-UT-HHW-FD, sampled March 27, 2019.

Table 2. Summary Statistics

CATEGORY	INITIAL SAMPLING RESULTS	RE-SAMPLING RESULTS (For Samples >15 ppb)				POST REMEDIATION RESULTS
	Sample Date: 12/15/18	Sample Date: N/A				
	First Draw	First Draw > 15 ppb	Water Fountain Follow up Flush Sample- Collected day before First Draw Sampling	Follow up Flush Collected 30 seconds after First Draw Sampling > 15 ppb	First Draw > 15 ppb	
Total Drinking	2	N/A				
Total Drinking > 20 ppb	0	N/A				
Total Cook/Brush	0	N/A				
Total Cook/Brush > 20 ppb	0	N/A				
Total Washing	14	N/A				
Total Washing > 20 ppb	0	N/A				
Outdoor	3	N/A				
Outdoor > 20 ppb	0	N/A				
Total Samples	19	N/A				
Total Samples > 20 ppb	0	N/A				

YOUTH CENTER

MAIN BUILDING

LEAD TESTING DEC 2018



NOTE: All results <1 ppb except as noted

SECONDARY MEETING AREA

KEY

- ◻ - Water Fountain Cooler
- - Sink
- △ - Hose Bib

MAIN ENTRANCE

△ NL-CT-WESTHOSE (B)-FD 2.6 ppb

NL-YC-WESTHOSE (A)-FD 2.7 ppb

GYM STORAGE

LOUNGE

TEEN LOUNGE

◻ NL-YC-LOBBY-WFC-FD

EXIT

EXIT

8.2 ppb
NL-YC-BOYSBATH-HHW (A)-FD
NL-YC-BOYSBATH-HHW (B)-FD
NL-YC-BOYSBATH-HHW (C)-FD
NL-YC-BOYSBATH-HHW (D)-FD
NL-YC-BOYSBATH-HHW (E)-FD

REGISTRATION
DESK

STORAGE

SNACK
AREA

NL-YC-SNACK-HHW-FD

OFFICES

NORTH
OUTSIDE
HOSE NOT
SAMPLED,
INSUFFICIENT
FLOW
TO BE LABELLED
NOT FOR
DRINKING.

GYM

NL-YC-UT-HHW-FD

RESTROOM

A B C D E

○ ○ ○ ○ ○

MAINT
CLOSET

◻ NL-YC-HALLWAY-WFC-FD

COMPUTER
ROOM

NL-YC-GIRLSBATH-HHW (A)-FD
NL-YC-GIRLSBATH-HHW (B)-FD
NL-YC-GIRLSBATH-HHW (C)-FD
NL-YC-GIRLSBATH-HHW (D)-FD
NL-YC-GIRLSBATH-HHW (E)-FD

A B C D E

○ ○ ○ ○ ○

RESTROOM

CLOSET

PIANO
ROOM

ACTIVITY
ROOM

○ NL-YC-RM109-HHW-FD

DANCE
ROOM

NL-YC-RM116-HHW-FD 5.5 ppb

MULTI-PURPOSE
ROOM

EXIT

EXIT

EXIT

△ NL-YC-EASTHOSE-FD 1.7 ppb

PRIMARY MEETING AREA

NAVY YOUTH CENTER ADDITION DRINKING WATER TESTING
29 HICKORY DRIVE, GROTON, CT 06340
DECEMBER 2018

SAMPLING LOCATION DESCRIPTION		INITIAL SAMPLING RESULTS Recommended Level = 15 ppb First Draw (ppb)			RE-SAMPLING RESULTS Recommended Level = 15 ppb		CORRECTIVE ACTIONS	POST REMEDIATION SAMPLING RESULTS Recommended Level = 15 ppb	
CATEGORY	ROOM	SAMPLE ID	Detection Limit = 1 ppb	Retest required?/Score?	Date Fixture	ROOM		SAMPLE ID	First Draw (ppb) Detection Limit = 1 ppb
Water Intended For:		SAMPLING DATE ---->			SAMPLING DATE ---->		SAMPLING DATE ---->		
		RESULTS DATE ---->			RESULTS DATE ---->		RESULTS DATE ---->		
Drinking	Corridor	YCAWaterCooler-L-FD	<1	No					
Drinking	Corridor	YCAWaterCooler-R-FD	<1	No					
Washing	Classroom 1	YCAClassroom1Sink-L-FD	<1	No					
Washing	Classroom 1	YCAClassroom1Sink-R-FD	<1	No					
Washing	Classroom 2	YCAClassroom2Sink-L-FD	<1	No					
Washing	Classroom 2	YCAClassroom2Sink-R-FD	<1	No					
Washing	Classroom 3	YCAClassroom3Sink-L-FD	<1	No					
Washing	Classroom 3	YCAClassroom3Sink-R-FD	<1	No					
Washing	Classroom 4	YCAClassroom4Sink-L-FD	<1	No					
Washing	Classroom 4	YCAClassroom4Sink-R-FD	<1	No					
Washing	Boys Bath	NL-YCA-BoysBath-LHWAL-FD	<1	No					
Washing	Boys Bath	NL-YCA-BoysBath-LHWBL-FD	<1	No					
Washing	Boys Bath	NL-YCA-BoysBath-LHWCL-FD	<1	No					
Washing	Girls Bath	NL-YCA-GirlsBath-LHWAL-FD	<1	No					
Washing	Girls Bath	NL-YCA-GirlsBath-LHWBL-FD	<1	No					
Washing	Girls Bath	NL-YCA-GirlsBath-LHWCL-FD	1	No	(See Note Below)				
Washing	Staff Sink	NL-YCA-StaffSink-FD	<1	No					
Utility	Girls's Closet	YCAGirlsCloset-FD	1	No					
Outdoor	Outside	NL-YCA-EXTHOSE-FD	1.6	No					

NOTE: Sample ID NL-YCA-GirlsBath-LHW(C)-FD was sampled on March 27, 2019.

Table 2. Summary Statistics

CATEGORY	INITIAL SAMPLING RESULTS Sample Date: 12/15/18	RE-SAMPLING RESULTS (For Samples >15 ppb) Sample Date: N/A			POST REMEDIATION RESULTS
		First Draw	First Draw > 15 ppb	Water Fountain Follow up	
Total Drinking	2	N/A			
Total Drinking > 15 ppb	0	N/A			
Total Cook/Brush	0	N/A			
Total Cook/Brush > 15 ppb	0	N/A			
Total Washing	15	N/A			
Total Washing > 15 ppb	0	N/A			
Total Utility	1	N/A			
Total Utility > 15 ppb	0	N/A			
Outdoor	1	N/A			
Outdoor > 15 ppb	0	N/A			
Total Samples	19	N/A			
Total Samples > 15 ppb	0	N/A			

NAVY PRIORITY AREA WATER TESTING PROGRAM - DEC 2018

YOUTH CENTER ADDITION (CH905)

SUBMARINE BASE NEW LONDON

SAMPLING LOCATIONS

NOTE: All lead results <1 ppb except as noted.

